

1 BASEMENT ABATEMENT PLAN
 AB-101 SCALE: 3/16" = 1'-0"

- LEGEND**
- (AC) ASBESTOS-CONTAINING
 - (RACM) REGULATED ASBESTOS CONTAINING MATERIAL
 - (LF) LINEAR FEET
 - (SF) SQUARE FEET
 - (TSI) THERMAL SYSTEMS INSULATION (PIPE AND FITTING INSULATION)
 - (FT1) LIGHT BROWN 9" X 9" FLOOR TILE AND ASSOCIATED MASTIC
 - (FT2) DARK BROWN 9" X 9" FLOOR TILE AND ASSOCIATED MASTIC
 - (FT3) GREEN 9" X 9" FLOOR TILE AND ASSOCIATED MASTIC
 - (FT4) TAN 12" X 12" FLOOR TILE AND ASSOCIATED MASTIC
 - (CMF) BROWN CARPET MASTIC
 - (FTM) BLACK FLOOR TILE MASTIC RESIDUE
 - (FDI) FIRE DOOR INSULATION
 - (1) WALL DEMOLITION BY ABATEMENT CONTRACTOR
 - (---) APPROXIMATE REMOVAL LOCATIONS AND EXTENTS

APPROXIMATE ASBESTOS REMOVAL QUANTITIES APPLICABLE TO AB-101 (FOR REFERENCE ONLY)

Material	Quantity
TSI	243 LF
FT1	328 SF
FT2	153 SF
FT3	60 SF
FT4	88 SF
CMF	120 SF
FTM	384 SF
FDI	36 SF

GENERAL ASBESTOS NOTES APPLICABLE TO AB-101 SERIES

- ASBESTOS ABATEMENT PLANS ARE BASED ON THE PRE-RENOVATION ASBESTOS SURVEY/INSPECTION REPORT PREPARED BY RAVI ENGINEERING & LAND SURVEYING, P.C. DATED 2015, AND SUPPLEMENTAL BULK SAMPLING PERFORMED ON AUGUST 9, 2017 AND SEPTEMBER 18, 2017.
- THE CONTRACTOR SHALL COORDINATE ALL ASBESTOS REMOVAL WORK WITH OWNER'S REPRESENTATIVE AND OTHER CONTRACTORS.
- CONTRACTOR SHALL BE RESPONSIBLE FOR OBTAINING A SITE SPECIFIC VARIANCE.
- WALLS SHALL BE REMOVED UNDER ASBESTOS ABATEMENT CONTRACT WORK WHERE INDICATED.
- ALL ASBESTOS MATERIALS REMOVED SHALL BE DISPOSED OF AS AN REGULATED ASBESTOS-CONTAINING MATERIAL (RACM).
- CONTRACTOR SHALL VERIFY EXISTING CONDITIONS, DIMENSIONS AND QUANTITIES, BEFORE START OF WORK.
- THE CONTRACTOR SHALL PERFORM ALL CONTRACT WORK IN ACCORDANCE WITH CONTRACT SPECIFICATIONS, NEW YORK STATE DEPARTMENT OF LABOR (NYSOL) INDUSTRIAL CODE RULE 56, OSHA 1926.1101, NESHAPS 40 CFR PART 61, AHERA 40 CFR PART 763 AND ALL OTHER APPLICABLE CODES.
- THE CONTRACTOR SHALL MAINTAIN SECURITY IN THE BUILDING AND WORK AREA AT ALL TIMES, FOR THE DURATION OF THE ASBESTOS REMOVAL PROJECT.
- ASBESTOS TRANSPORT ROUTE TO BE COORDINATED WITH THE OWNER'S REPRESENTATIVE.
- CONTRACTOR SHALL COORDINATE SHUT DOWN AND LOCK OUT OF ELECTRICAL POWER WITH OWNER'S REPRESENTATIVE. ALL TEMPORARY POWER TO THE WORK AREA SHALL BE BROUGHT IN FROM OUTSIDE THE WORK AREA THROUGH A GROUND-FAULT CIRCUIT INTERRUPTER AT THE SOURCE OF THE POWER.
- MOVEABLE OBJECTS SHALL BE REMOVED BY THE ABATEMENT CONTRACTOR AND SHALL BE PRE-CLEANED PER CODE RULE 56 AND SHALL BE DISPOSED OF AS A NON-CONTAMINATED WASTE.
- VARIATIONS (+/- 10%) IN QUANTITIES AND LOCATIONS OF ACM SHALL BE CONSIDERED AS HAVING NO IMPACT ON CONTRACT PRICE AND/OR SCHEDULE OF THIS CONTRACT.
- THE OWNER IS RESPONSIBLE TO CONTRACT FOR NYSOL PROJECT MONITORING / AIR SAMPLING TECHNICIAN SERVICES. OSHA PERSONAL AIR MONITORING IS THE RESPONSIBILITY OF THE CONTRACTOR.
- CONTRACTOR SHALL REQUEST AND RECEIVE PROJECT MONITOR AND OWNER'S REPRESENTATIVE APPROVAL BEFORE ASBESTOS REMOVAL IS UNDERTAKEN.
- CONTRACTOR TO HEPA VACUUM EXISTING NON-MOVABLE EQUIPMENT PRIOR TO COVERING WITH PROTECTIVE PLASTIC SHEETING.
- UNDER NO CIRCUMSTANCES SHALL CONTAMINATED WASTEWATER ENTER THE SANITARY SEWER SYSTEM. ALL WASTE WATER SHALL BE FILTERED THROUGH A SYSTEM WITH AT LEAST 5.0 MICRON PARTICLE SIZE COLLECTION CAPABILITY.
- IF WATER LEAKS THROUGH THE CONTAINMENT AREAS, OR FROM THE DECONTAMINATION AREA, THE CONTRACTOR SHALL BE RESPONSIBLE FOR ALL WATER DAMAGE. CONTRACTOR SHALL DOCUMENT ALL PRE-EXISTING WATER DAMAGE PRIOR TO ESTABLISHING CONTAINMENT AREAS.
- IF SUSPECT OR ASBESTOS MATERIAL IS DISCOVERED, NOT PREVIOUSLY IDENTIFIED, CEASE OPERATIONS AND NOTIFY THE OWNER AND/OR OWNER'S REPRESENTATIVE IMMEDIATELY.
- CONTRACTOR SHALL IDENTIFY AND INCLUDE IN THEIR BID ALL DEMOLITION REMOVALS SHOWN ON THE ARCHITECTURAL, PLUMBING, ELECTRICAL AND MECHANICAL DEMOLITION PLANS. THE CONTRACTOR SHALL BE RESPONSIBLE TO OBTAIN A PROFESSIONAL ENGINEER FOR DETERMINING THE NEED LOCATION AND MAINTENANCE OF ALL TEMPORARY SHORING AND BRACING. TEMPORARY SHORING AND BRACING SHALL REMAIN IN PLACE UNTIL PERMANENT LOAD PATHS HAVE BEEN ESTABLISHED. THE CONTRACTOR SHALL BE RESPONSIBLE FOR PROVIDING SHOP DRAWINGS AND CALCULATIONS FOR SHORING AND BRACING THE BUILDING STRUCTURE. SUBMITTALS SHALL BE SCALED AND SIGNED BY A P.E. LICENSED TO PRACTICE IN THE STATE OF NEW YORK PRIOR TO STARTING CONSTRUCTION.
- REFER TO ARCHITECTURAL DRAWING FOR GENERAL DEMOLITION NOTES.
- APPROVAL OF THE QUANTITY AND EXTENT OF THIS WORK MUST BE APPROVED BY CONSULTANT AND OWNER PRIOR TO THE START OF WORK.
- IF THERE IS A CONFLICT BETWEEN THE DRAWINGS AND SPECIFICATIONS, THE MOST STRINGENT SHALL APPLY.
- ALL PRE-ABATEMENT SUBMITTALS SHALL BE SUBMITTED BY THE CONTRACTOR AND APPROVED BY THE ENGINEER PRIOR TO THE START OF ANY/ALL ABATEMENT WORK.

LEAD PAINT NOTE APPLICABLE TO AB-101

- SURFACES CONTAINING LEAD PAINT ARE PRESENT IN THE RENOVATION AREA. ALTERATIONS TO PAINTED SURFACES CONTAINING LEAD SHALL BE PERFORMED BY EITHER THE ABATEMENT OR GENERAL CONTRACTOR AS DESCRIBED IN THE PROJECT SPECIFICATIONS OR DIRECTED BY THE ENGINEER. SURFACES WHERE DISTURBANCE WILL OCCUR, SHALL BE PERFORMED IN ACCORDANCE WITH 29 CFR 1926.62.
- IN THE EVENT THERE IS A CONFLICT BETWEEN THE DRAWINGS AND SPECIFICATIONS, THE MOST STRINGENT REGULATION SHALL APPLY.
- ALL PRE-ABATEMENT REQUIRED SUBMITTALS SHALL BE RECEIVED AND APPROVED BY THE ENGINEER PRIOR TO STARTING DEMOLITION.

ASBESTOS ABATEMENT NOTES APPLICABLE TO AB-101

- (TSI) REMOVE AC THERMAL SYSTEMS INSULATION CONSISTING OF MUD FITTINGS AND PIPE INSULATION AND DISPOSE OF AS AN RACM. MUD FITTINGS AND PIPE INSULATION SHALL BE REMOVED THREE FEET ON EACH SIDE OF THE DEMISING WALL SCHEDULED FOR DEMOLITION. EXPOSED EDGES OF TSI SHALL BE ENCAPSULATED WITH LAG CLOTH. CONTRACTOR TO COORDINATE REMOVALS WITH THE GENERAL CONTRACTOR.
- (FT1) REMOVE AC LIGHT BROWN W/ RED AND WHITE STREAKS 9" X 9" FLOOR TILE, AC BLACK FLOOR TILE MASTIC INCLUDING NON-AC FLOOR LEVELER, NON-AC COVE MOLDING, COVE MOLDING MASTIC, DOOR STOPS AND DISPOSE OF AS AN RACM.
- (FT2) REMOVE AC DARK BROWN W/ RED AND WHITE STREAKS 9" X 9" FLOOR TILE, AC BLACK FLOOR TILE MASTIC INCLUDING NON-AC FLOOR LEVELER, NON-AC COVE MOLDING, COVE MOLDING MASTIC, DOOR STOPS AND DISPOSE OF AS AN RACM.
- (FT3) REMOVE AC GREEN 9" X 9" FLOOR TILE, AC BLACK FLOOR TILE MASTIC INCLUDING NON-AC FLOOR LEVELER, NON-AC COVE MOLDING, COVE MOLDING MASTIC, DOOR STOPS AND DISPOSE OF AS AN RACM.
- (FT4) REMOVE TAN 12" X 12" FLOOR TILE, AC YELLOW FLOOR TILE MASTIC INCLUDING NON-AC FLOOR LEVELER, NON-AC COVE MOLDING, COVE MOLDING MASTIC, DOOR STOPS AND DISPOSE OF AS AN RACM.
- (CMF) REMOVE CARPET AND AC BROWN CARPET MASTIC AND DISPOSE OF AS AN RACM.
- (FTM) REMOVE AC BLACK FLOOR TILE MASTIC RESIDUE INCLUDING NON-AC FLOOR LEVELER, NON-AC COVE MOLDING, COVE MOLDING MASTIC, DOOR STOPS AND DISPOSE OF AS AN RACM.
- (FDI) REMOVE AND DISPOSE OF TWO FIRE DOORS CONTAINING ASSUMED ASBESTOS AND DISPOSE OF AS AN RACM.

DEMOLITION NOTES APPLICABLE TO AB-101

- (1) REMOVE ELECTRICAL WALL PLATES, ELECTRICAL BOXES, WIRE MOLD AND WIRE, DOOR/WINDOW MOLDING AND ANY OTHER APPURTENANCES ATTACHED TO THE WALL AND DISPOSE OF AS CONSTRUCTION AND DEMOLITION DEBRIS. REMOVE NON-AC WALL COVERING, NON-AC DRYWALL, NON-AC JOINT COMPOUND, WALL PLASTER ALL LAYERS, WOOD PANELING INCLUDING WALL STUDS FULL DEPTH WITHIN LIMITS SHOWN AND DISPOSE OF AS CONSTRUCTION AND DEMOLITION DEBRIS. CONTRACTOR IS TO LEAVE 12" AT THE BASE OF EXISTING WALLS IN PLACE FOR REMOVAL UNDER ABATEMENT ASSUMING FLOOR TILES AND MASTIC PRESENT UNDER WALL.

515 Broadway, Albany, New York 12207-2964
 One Penn Plaza, 52 Floor, NY, NY 10119-0098
 539 Franklin St., Buffalo, NY 14202-1109
 WWW.DASNY.ORG

DELTA ENGINEERS, ARCHITECTS & LAND SURVEYORS
 860 HOSPIER ROAD
 ENWELL, NY 13760
 807-231-6500
 2016 194 006

RAVI ENGINEERING & LAND SURVEYING
 210 SOUTH CLINTON AVE. #1
 ROCHESTER, NY 14619
 585-223-3660

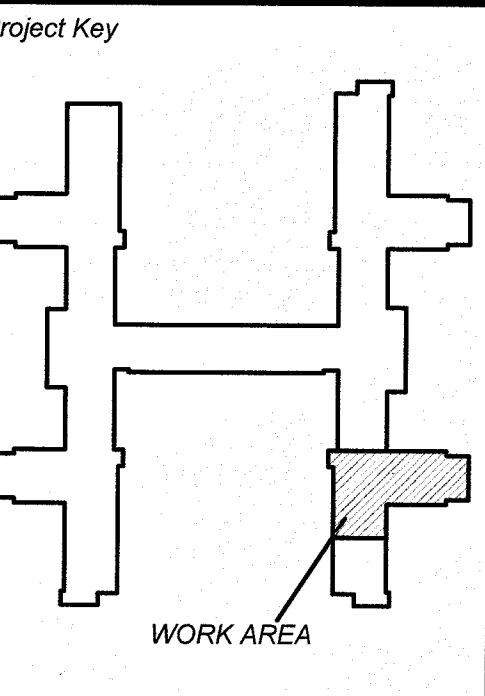

Client

NEW YORK STATE OF OPPORTUNITY. **Office of Mental Health**

Project Title
 B39 ASBESTOS ABATEMENT

CENTRAL NEW YORK PSYCHIATRIC CENTER

Drawing Title
 BASEMENT ABATEMENT PLAN

Phase
ISSUE FOR BID

Drawn By: **CMS** Checked By: **GRB** Date: **03/16/2018**

Seal & Signature
 DASNY Project No: 34173099999
 Drawing Number: **AB-101**
 Drawing 1 of 1